



Two Rivers. No Limits

PERMIT APPLICATION

PERMIT #

1407 N 8TH • P.O. BOX 336 • NEODESHA, KS 66757
 PHONE (620) 325-2828 • FAX (620) 3252481 • WEBSITE: NEODESHAKS.ORG

Permit is valid only after signature of building official

PROJECT SITE INFORMATION		
PROJECT SITE ADDRESS:		DATE:
PROJECT VALUE: \$	RECIPT #:	ZONING:
PERMIT TYPE: <input type="checkbox"/> BUILDING <input type="checkbox"/> MECHANICAL <input type="checkbox"/> ELECTRICAL <input type="checkbox"/> PLUMBING <input type="checkbox"/> IRRIGATION/ SPRINKLER		
IS PROPERTY IN FLOOD ZONE? <input type="checkbox"/> YES <input type="checkbox"/> NO EPA PAMPHLET: WAS PROPERTY BUILT BEFORE 1978? <input type="checkbox"/> YES <input type="checkbox"/> NO		
WILL INSURANCE PROCEEDS BE USED? <input type="checkbox"/> YES <input type="checkbox"/> NO # of Rooms: _____ # of Stories: _____ # Parking Spaces: _____		
Building Class: <input type="checkbox"/> SINGLE FAMILY <input type="checkbox"/> TWO FAMILY <input type="checkbox"/> MULTI-FAMILY <input type="checkbox"/> ACCESSORY <input type="checkbox"/> COMMERCIAL <input type="checkbox"/> INDUSTRIAL <input type="checkbox"/> CHURCH <input type="checkbox"/> OTHER (Please Specify) _____		
Structure Type: <input type="checkbox"/> MASONRY <input type="checkbox"/> WOOD <input type="checkbox"/> STEEL <input type="checkbox"/> CONCRETE <input type="checkbox"/> OTHER (Explain): _____		

CONTACT INFORMATION		
OWNER NAME:		TENANT BUSINESS NAME (Commercial) :
OWNER MAILING ADDRESS: STREET		
CITY	STATE	ZIP
OWNER PHONE:		OWNER EMAIL:
CONTRACTOR NAME:		
CONTRACTOR ADDRESS: STREET CITY STATE ZIP		
CONTRACTOR PHONE:		CONTRACTOR EMAIL:
ROOFING REGISTRATION #:		
PRIMARY CONTACT: <input type="checkbox"/> OWNER <input type="checkbox"/> CONTRACTOR <input type="checkbox"/> OTHER (Please Specify) _____		
CONTACT NAME:		CONTACT PHONE:
		CONTACT EMAIL:

PERMIT COST					
RESIDENTIAL			COMMERCIAL		
ITEM	PRICE	✓	ITEM	PRICE	✓
New Construction	\$ 200.00		New Construction	\$ 400.00	
Remodeling	\$ 30.00		Remodeling	\$ 90.00	
New Construction - Accessory Building	\$ 25.00		New Construction - Accessory Building	\$ 25.00	
Fence	\$ 20.00		Fence	\$ 25.00	
Demolition	\$ 50.00		Demolition	\$ 150.00	
Demolition - Accessory Building	\$ 30.00		Demolition - Accessory Building	\$ 300.00	
Roofing	\$ 25.00		Roofing	\$ 50.00	
Electrical	\$ 25.00		Electrical	\$ 25.00	
Plumbing	\$ 25.00		Plumbing	\$ 25.00	
Mechanical	\$ 25.00		Mechanical	\$ 25.00	
Pressure Test	\$ 25.00		Pressure Test	\$ 25.00	
Sewer Tapping Fee (Inside City Limits)	\$ 100.00		Sewer Tapping Fee (Inside City Limits)	\$ 200.00	
Sewer Tapping Fee (Outside City Limits)	\$ 300.00		Sewer Tapping Fee (Outside City Limits)	\$ 500.00	
Irrigation/ Sprinkler	\$ 15.00		Irrigation/ Sprinkler	\$ 25.00	
Building Relocation/ Move	\$ 25.00		Building Relocation/ Move	\$ 50.00	
Sidewalk Installation (Material Cost Billed to Owner)	\$ 00.00		Sign	\$ 50.00	
Concrete (Sidewalk, Driveway, etc.)	\$ 10.00		Concrete (Sidewalk, Driveway, etc.)	\$ 25.00	
TOTAL	\$		TOTAL	\$	

PERMIT #

JOB SPECIFICATIONS							
MECHANICAL				PLUMBING			
FIXTURES	✓	FIXTURES	✓	FIXTURES	✓	FIXTURES	✓
A/C – Air Handling Units		Gas Piping		Backflow Preventer		Shower, Tub, or Combo	
Boiler		Gas Range		Clothes Washer		Sink	
Clothes Dryer		Heat Pump & Ductless		Dishwasher		Toilet	
Duct System		Refrigeration		Drinking Fountain		Urinal	
Exhaust Fans		Commercial Ventilation		Floor Drain		Wastewater Piping Repair	
Exhaust Hood		Gas Water Heater		Hose Bibb		Water Piping Repair	
Forced Air Systems		Wood Stove		Interceptor- Grease		Water Service	
Gas Fireplace/Insert/Log		Other: _____		Interceptor- Sand/Oil		Water Valves/ Fixtures	
Pressure Test		Other: _____		Medical Gas		Water Heater	
SPRINKLER/ SUPPRESSION SYSTEM				Roof Drains		Sewer Tapping	
Water Suppression System		Irrigation		Sewage Ejector/ Sump Pump		Other: _____	
Chemical Suppression		Other: _____					
ELECTRICAL							
120 Volt Circuit		240 Volt Circuit		Motors/ AC (1 HP or less)		Outlets Add (Existing Circuit)	
Pool/ Hot Tub/ Jacuzzi		Clothes Dryer		Motors/ AC (Over 1 HP)		Smoke Detectors	
Construction Service/ Temporary Service		New Service (Outside Disconnect Required)		Heating Appliance (4500 watt or less)		Range/ Heating Device (Over 4500 watt)	
Dedicated Power Circuit		Electric Water Heater		Light Fixture(s)		Low Voltage	
Generator		New Panel		Water Well Motor		Photovoltaic (Solar) System	
Transfer Switch		Rewire		Other: _____		Other: _____	

DESCRIPTION OF WORK

ALL BUILDING PROJECTS MUST ATTACH DETAILED SITE PLANS WITH ALL REQUIRED INFORMATION:

- Dimensions of lot
- Measurements of existing & proposed buildings
- Designate existing buildings
- Designate additions/ alterations
- Indicate street(s) / alley(s)
- Indicate North direction

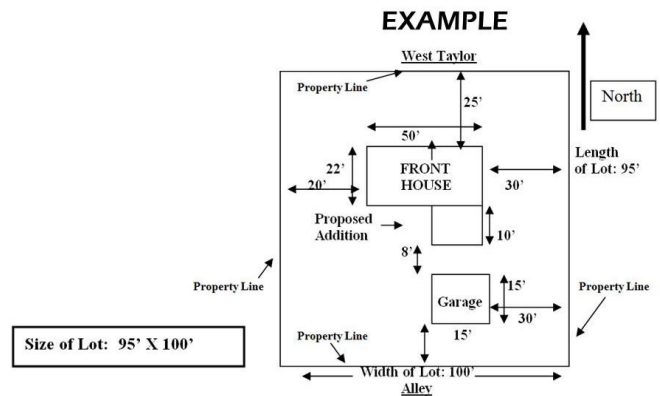

ACKNOWLEDGEMENT: I have reviewed this application and confirm the information contained herein is true and correct. Work done pursuant to this permit must comply with current federal, state, and local law. The granting of a permit only authorizes approved work and no deviations therefrom. Deviations must first be authorized in writing from the Building Official before being authorized under any circumstance. I am the owner, or I am authorized by the owner of this property to perform the work for which application is made. I recognize that a 24 hour notice must be given for inspections. All excavations of any depth must call "DIG SAFE" at #811 before any work commences.

SIGNATURES	
Owner/ Authorized Agent:	Date:
Building Official:	Date: <input type="radio"/> Approved <input type="radio"/> Denied